

# WIMCY welcome into my CHURCH YARD



With the support of:



UIA2020RIO. 27<sup>th</sup> World Congress of Architects  
All the worlds. Just one world. Architecture 21  
Maré-Cidade International Students Competition



Diana Negoescu

Ilham Al-Hajjar

Gabriella D. B. Monteiro

Sophia A. Thomas

# WIMCY welcome into my CHURCH YARD



The Mare community is one of the oldest favelas in Rio. It is located beside one of the main freeways in Rio with the federal University of Rio on the island beside it. Today it is a living heritage of hundreds of years of immigrants and locals living together in the community.

The unique formation of favelas presents many positive and negative urban situations for the community. Our proposal is to strengthen the resilience of these communities in areas surrounding the Churches through actions of the local community in partnership with strong institutions present there such as the



37.6 % OF PEOPLE HAVE ONLY COMPLETED MIDDLE SCHOOL



DEVELOP SUSTAINABLE CITIES AND COMMUNITIES



PROVIDE DECENT WORK AND ECONOMIC GROWTH



PARTNER WITH STRONG INSTITUTIONS TO BRING PEACE AND JUSTICE



68.4 % OF THE POPULATION ATTEND CHURCH



INDUSTRY, INNOVATION AND INFRASTRUCTURE



GOOD HEALTH AND WELL-BEING



START WITH THE COMMUNITY

## The Local Churches.

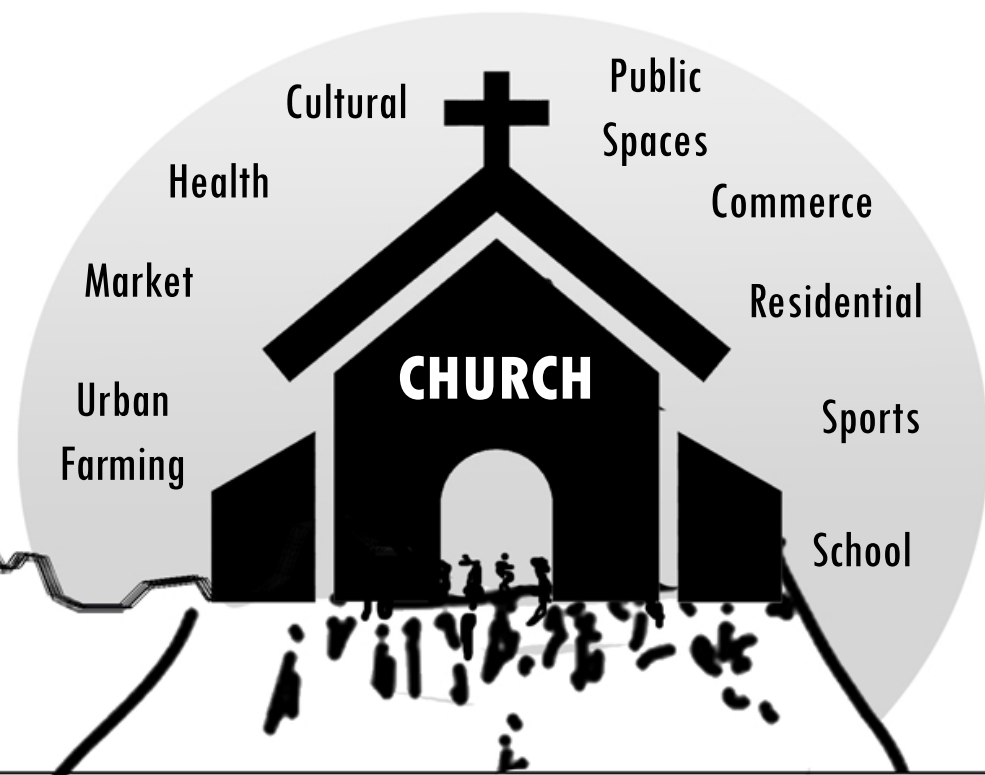

# TODAY

# TOMORROW

- CHURCH
- ABANDONED/UNKOWN
- SERVICES
- EDUCATION
- SPORTS
- URBAN FARMING
- PUBLIC SPACE
- RESIDENTIAL
- RECYCLING
- STOREHOUSE/INDUSTRIAL
- COMMERCIAL/FOOD



1:4000



1:4000

## Residential

A multifunctional plot with RESIDENTIAL and PUBLIC functions. The lower part = communal space and upper part = free expansive housing units with green roofs connected through bridges.

## Retail Street

This RETAIL STREET has been rearranged to better accommodate the existing informal commercial infrastructure. One-way street+CUBEs+green pockets= safe, orderly, pedestrian friendly environment.

## Urban Farming

The urban farm aims to BUILD COMMUNITY + help locals to INVEST IN GREEN SPACES. This project aims to introduce a healthy, sustainable, outdoor activity into a forgotten plot in the former industrial park of Mare.

## Market Hall

This proposal creates a designated market area in the community with a variety of FOOD and RETAIL stalls. Part is OUTDOOR and the INDOOR part located in the renovated building which is remodeled into a large open plan space and gallery

## Sports

The sports halls are built into two existing warehouses in the plot. The proposal is that it become a center for children in the community to have the opportunity to come together and develop their athletic skills. Engaging in healthy activity.

## Educational

This is the Educational plot proposing that these buildings be transformed into TRADE SCHOOLS. With a dormitory and a career center to assign jobs to students when they graduate.

# Sports

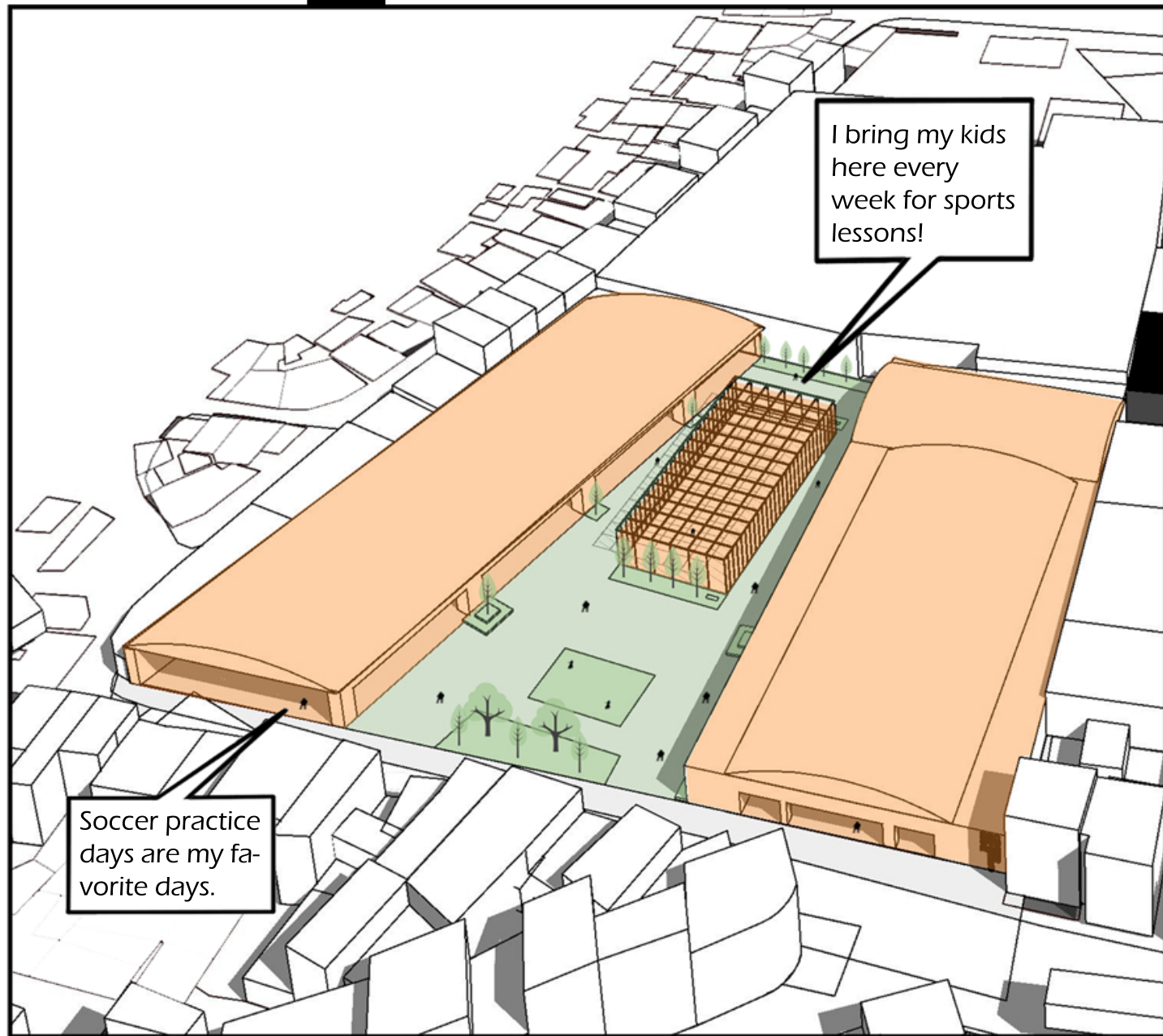

# Residential

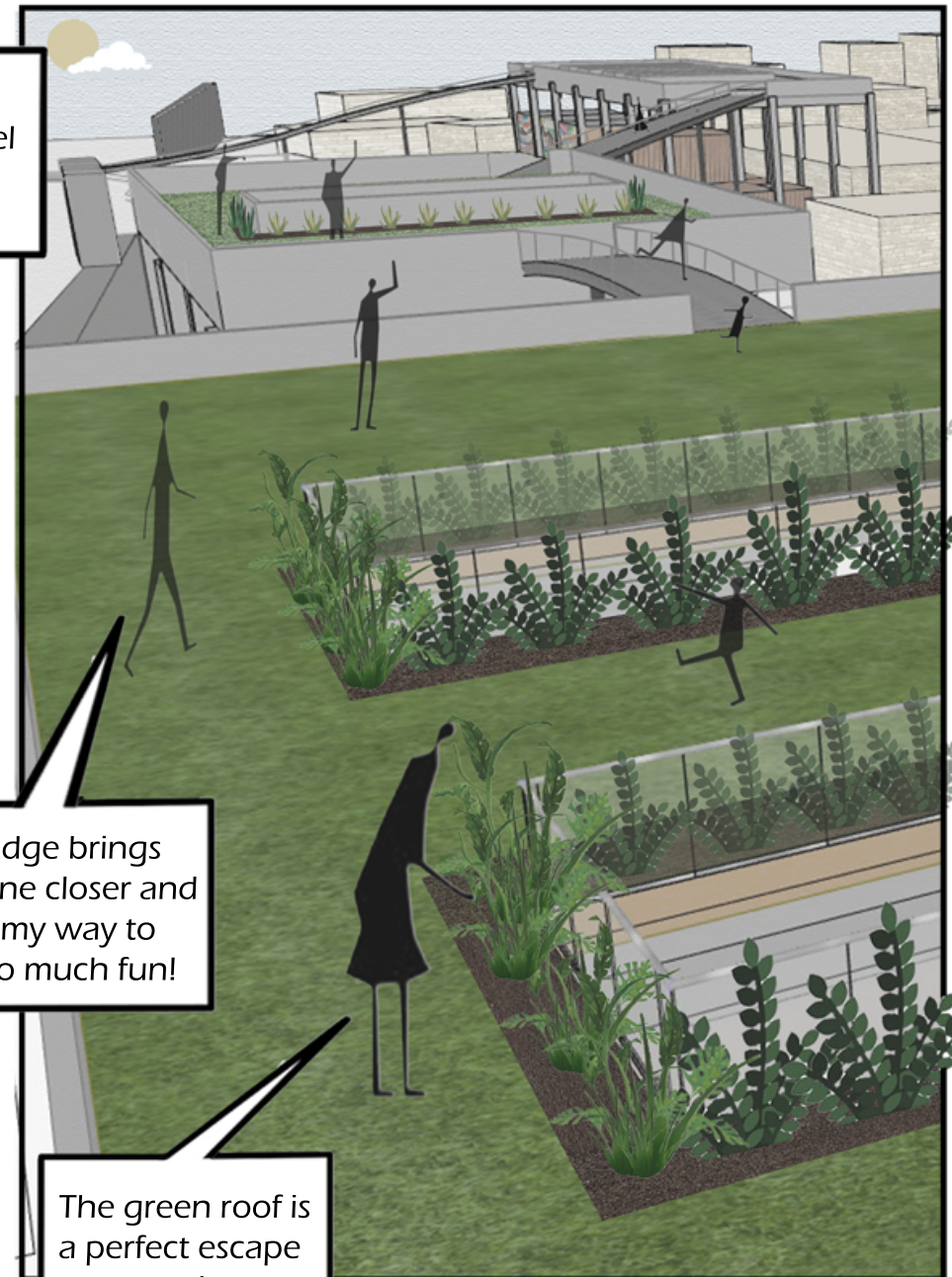
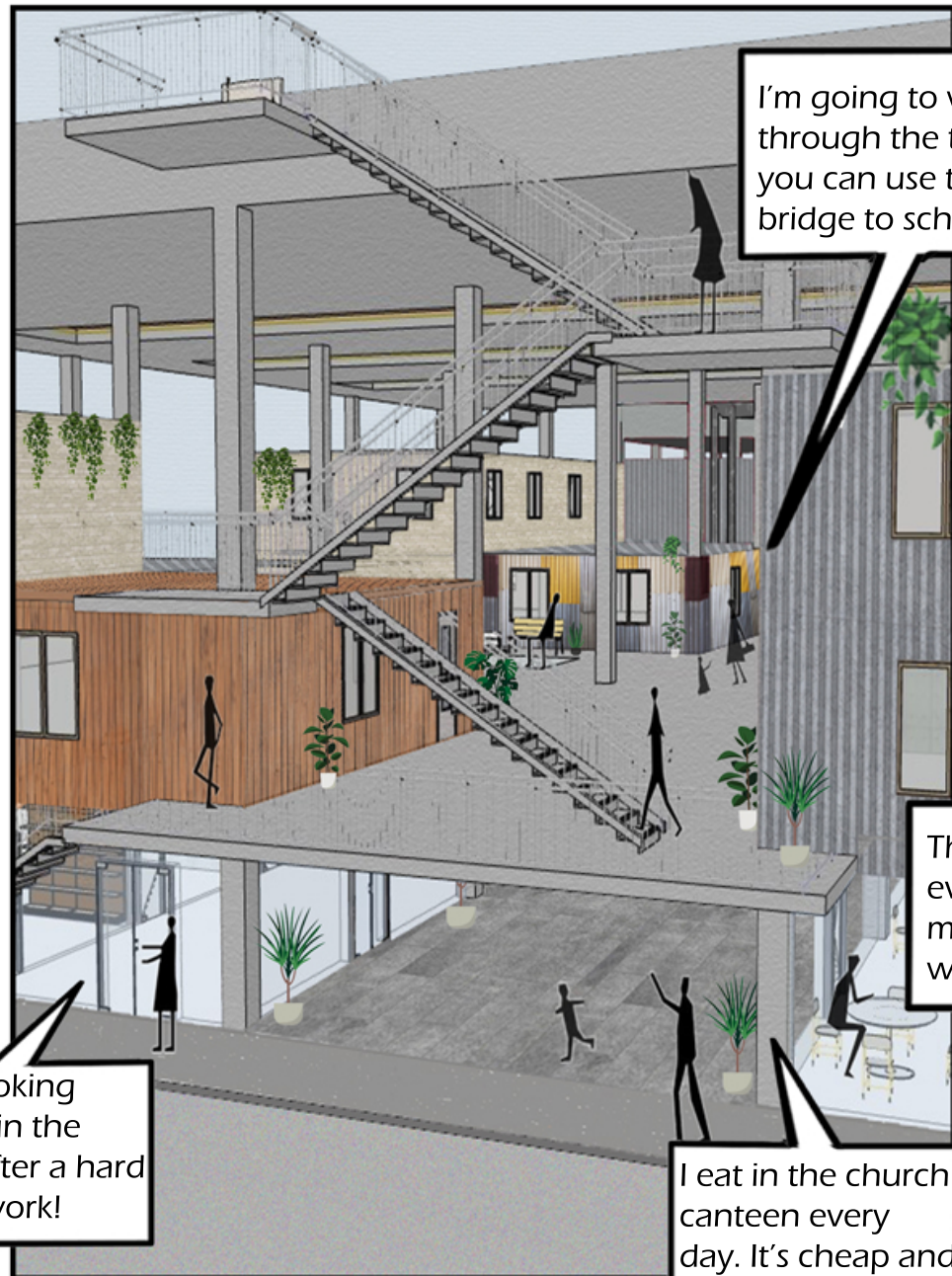
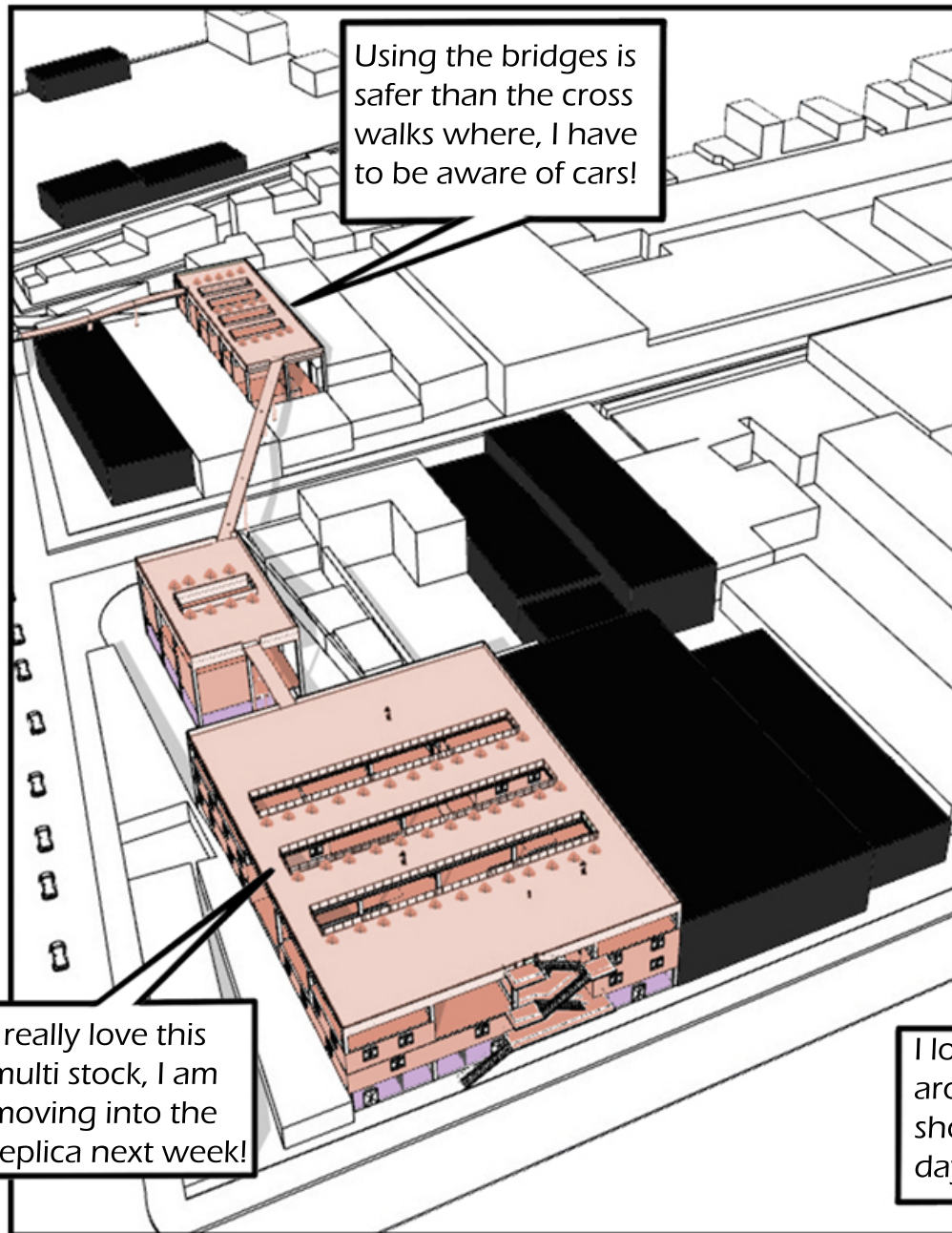

# Educational

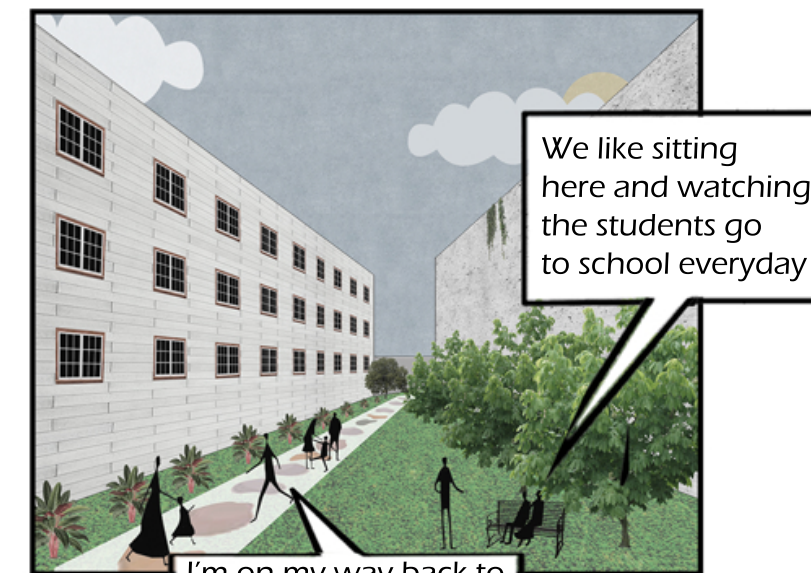
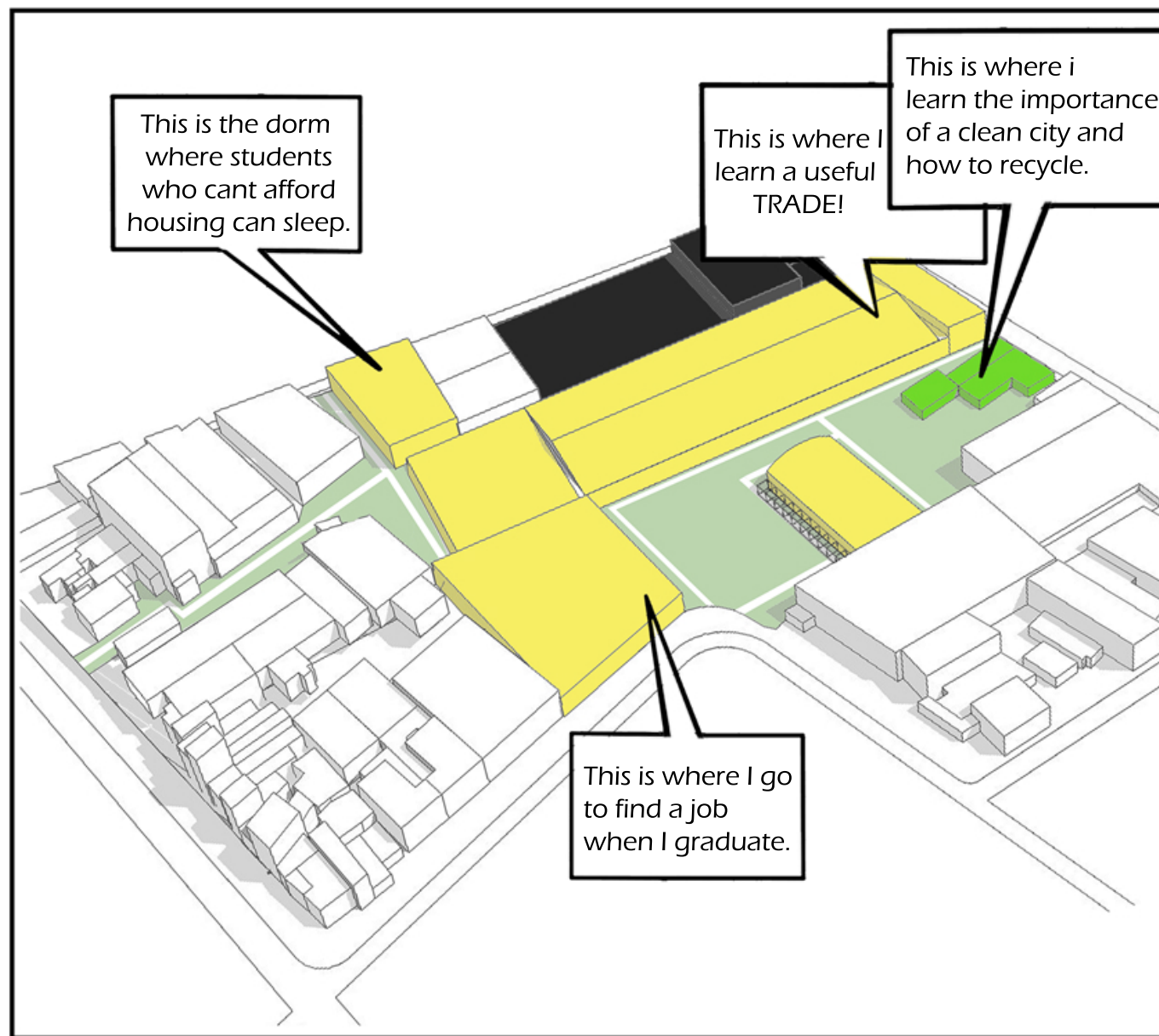

# Urban Farming

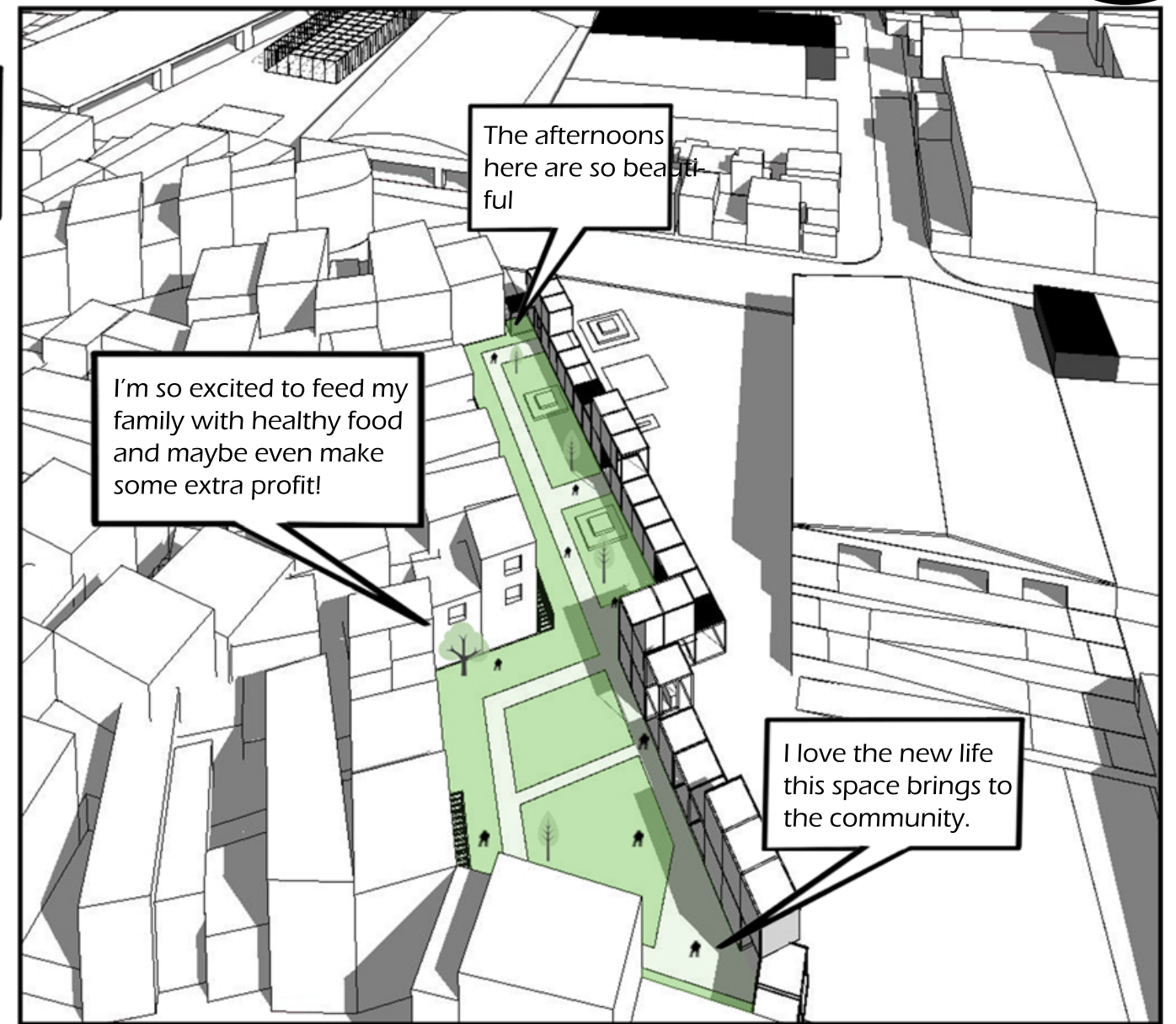

# Market Hall

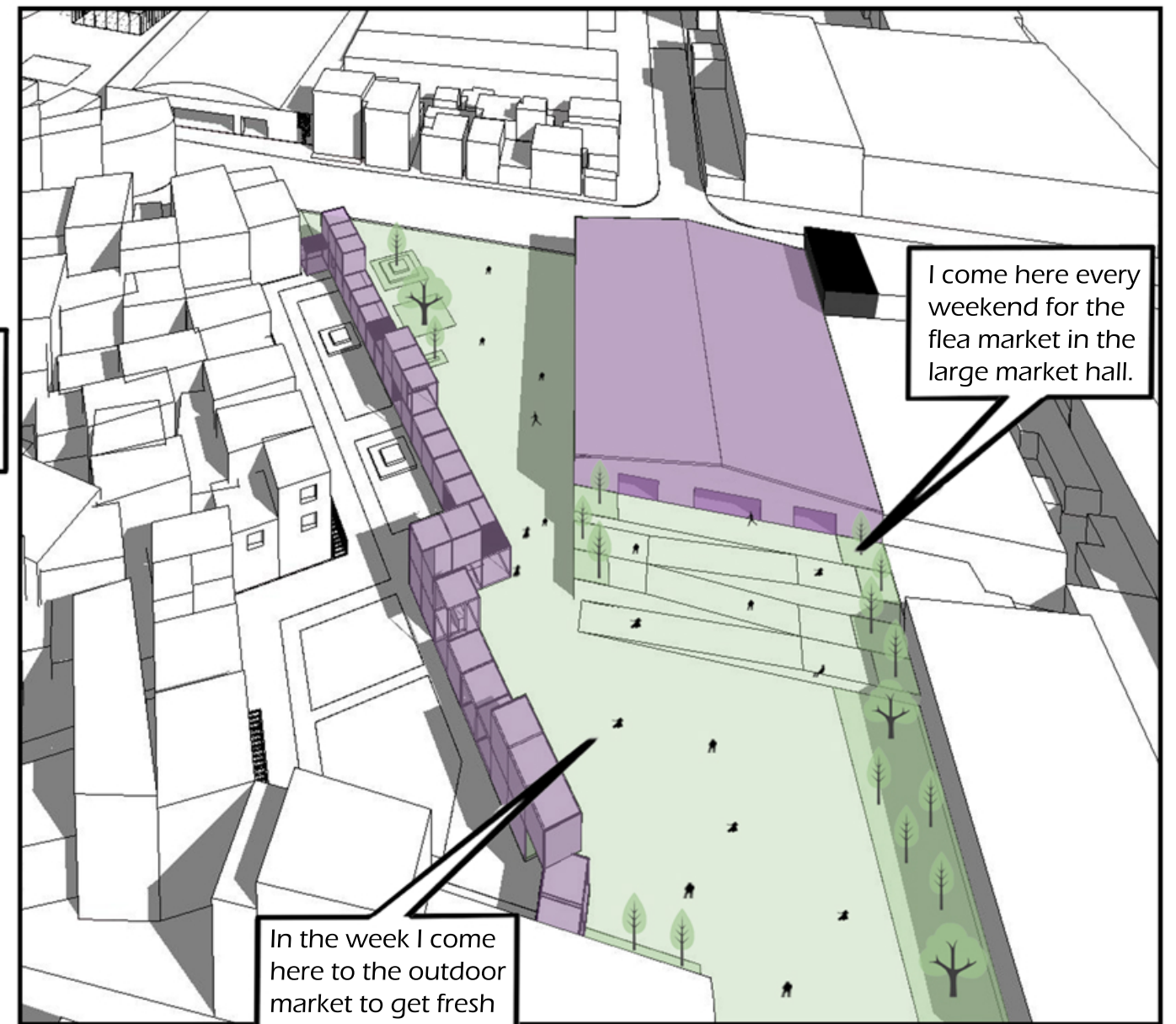



# Retail Street



This is my favorite place for shopping, it is safe with a pleasant environment.

The new park has become an attraction and my business is booming

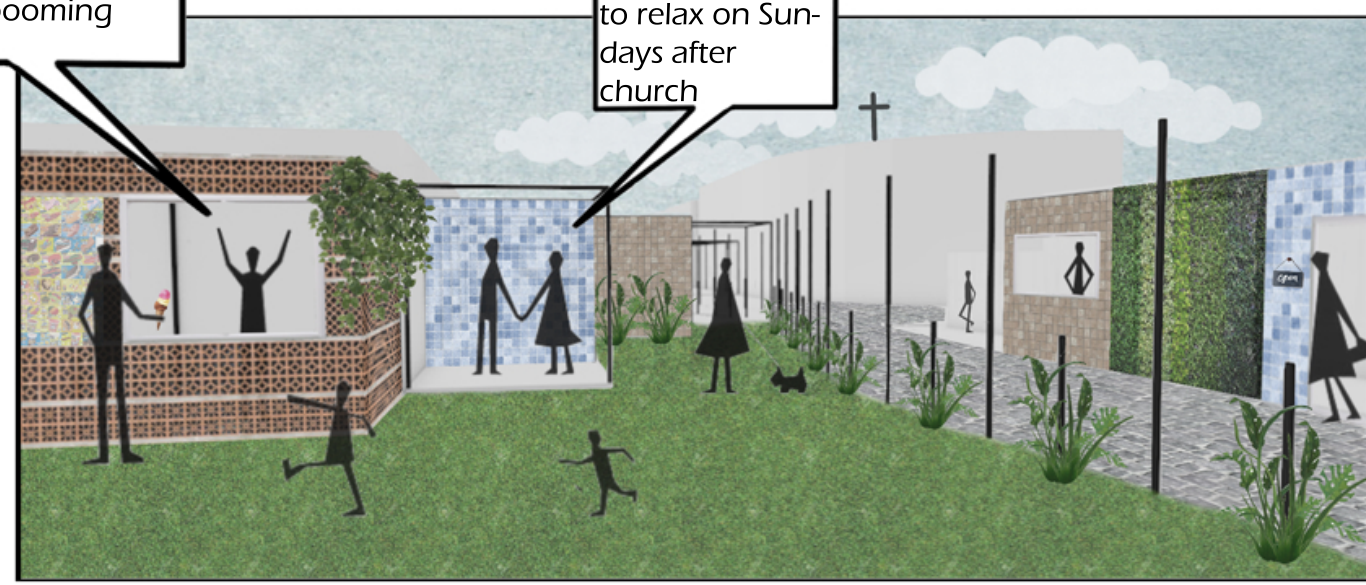

Its a great place to relax on Sundays after church

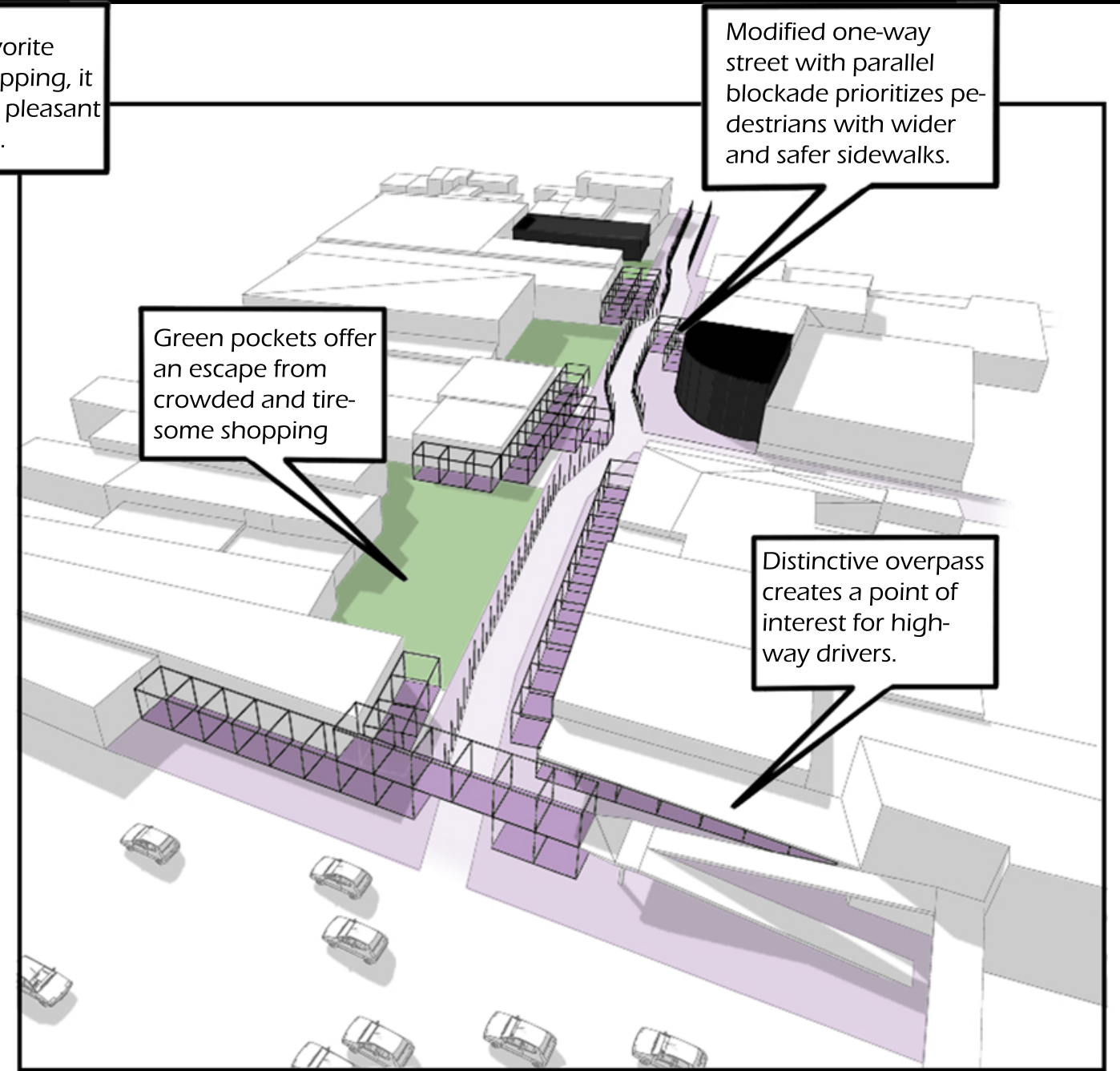

Green pockets offer an escape from crowded and tiresome shopping

Modified one-way street with parallel blockade prioritizes pedestrians with wider and safer sidewalks.

Distinctive overpass creates a point of interest for highway drivers.



# The CUBE concept

## Community Unification through Building up Economically

As a result of the design process the CUBE emerged as a unit which can be easily used in building up new structures into the new and existing urban settings. The proposal is that it can be easily used and built by the community giving them flexibility to finish the building with materials found locally and bring their creativity into action. It is a concept to create a ecological way of building which is easy and brings unification in design and between people in the community. It is also important to begin with small interventions which use less resources and then step into larger interventions as the need grows. The CUBE provides an easy way to make this happen in various contexts.

### The Structure

COLUMNS

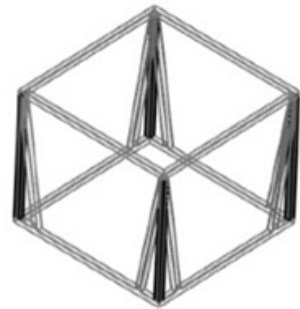

RINGBEAMS

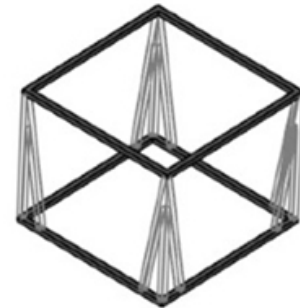

BRACINGS

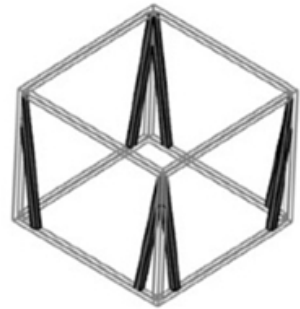

FINAL STRUCTURE

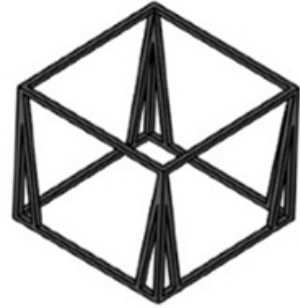

### The Flexibility

